

TECHNICAL DATA SHEET



KRASO® Sealing Insert Type ED/T - split

Application areas

Split design for retrofit installation, against pressing and non-pressing water, for core drillings or casings for installation of pipes or cables, including Torque Control Nut **KRASO® DKM**

Material

Clamping plates	5 mm non-corrosive stainless steel
Bolts	non-corrosive stainless steel
Washers	non-corrosive stainless steel
Nuts	Torque Control Nut KRASO® DKM
Seal	20 mm EPDM 50° +/-5° Shore

Technical details

- Torque Control Nut **KRASO® DKM**: integrated torque limiter – no torque wrench required
- Certified with the quality seal of the FHRK e.V.
- Radon tightness IAF tested – meets the requirements for radon precautionary areas according to FHRK leaflet MB 101
- Axial bending of the media pipes up to 8° possible
- MPA-tested gas and water pressure tightness up to 1,0 bar

Test certificates [In our download area](#)

Product image



Technical drawing

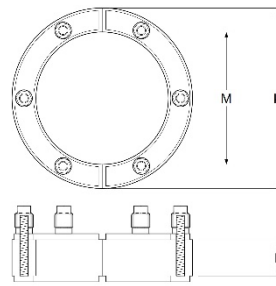

TECHNICAL DATA SHEET



KRASO® Sealing Insert Type ED/T - split

Size - 80

K	80	80	80		
M	25	32	43		
L	20	20	20		
Clamping range	20-26	29-35	38-44		
Weight	0,30	0,27	0,25		
Item no.	KDI080EDG022	KDI080EDG032	KDI080EDG040		

Size - 100

K	100	100	100	100	
M	32	43	50	63	
L	20	20	20	20	
Clamping range	29-35	38-44	48-51	58-64	
Weight	0,5	0,47	0,46	0,45	
Item no.	KDI100EDG032	KDI100EDG040	KDI100EDG048	KDI100EDG060	

Size - 125

K	125	125	125		
M	63	75	80		
L	20	20	20		
Clamping range	58-64	72-78	75-81		
Weight	0,76	0,68	0,68		
Item no.	KDI125EDG060	KDI125EDG075	KDI125EDG078		

Size - 150

K	150	150	150	150	
M	75	80	90	110	
L	20	20	20	20	
Clamping range	70-76	75-81	85-91	105-111	
Weight	0,80	0,78	0,78	0,70	
Item no.	KDI150EDG075	KDI150EDG078	KDI150EDG088	KDI150EDG108	

Size - 200

K	200	200	200	200	200	200
M	110	114	125	135	140	160
L	20	20	20	20	20	20
Clamping range	105-111	113-119	120-126	130-136	135-141	155-161
Weight	1,80	1,70	1,50	1,20	1,10	1,00
Item no.	KDI200EDG108	KDI200EDG114	KDI200EDG123	KDI200EDG133	KDI200EDG139	KDI200EDG158

TECHNICAL DATA SHEET



KRASO® Sealing Insert Type ED/T - split

Size - 250

K	250	250	250	250	250	
M	160	170	180	200	210	
L	20	20	20	20	20	
Clamping range	156-162	165-171	176-182	196-202	206-212	
Weight	2,50	2,40	1,5	1,3	1,2	
Item no.	KDI250EDG158	KDI250EDG168	KDI250EDG177	KDI250EDG200	KDI250EDG210	

Size - 300

K	300	300	300	300	300	
M	200	210	219	225	250	
L	20	20	20	20	20	
Clamping range	196-202	206-212	215-221	221-227	246-252	
Weight	3,40	3,30	2,25	2,20	2,00	
Item no.	KDI300EDG200	KDI300EDG210	KDI300EDG219	KDI300EDG225	KDI300EDG250	

Size - 350

K	350	350	350	350	350	
M	200	210	219	225	250	
L	20	20	20	20	20	
Clamping range	196-202	206-212	215-221	221-227	246-252	
Weight	2,0	2,0	2,0	2,0	2,0	
Item no.	KDI350EDG200	KDI350EDG210	KDI350EDG219	KDI350EDG225	KDI350EDG250	

Size - 400

K	400	400	400	400		
M	273	280	315	326		
L	20	20	20	20		
Clamping range	269-275	276-282	311-317	322-328		
Weight	4,40	4,30	4,00	3,90		
Item no.	KDI400EDG273	KDI400EDG280	KDI400EDG315	KDI400EDG326		

Size - 500

K	500	500	500			
M	400	429	450			
L	20	20	20			
Clamping range	397-402	426-431	447-452			
Weight	6,70	4,0	3,6			
Item no.	KDI500EDG400	KDI500EDG429	KDI500EDG450			

•K | core hole (mm) •M | media lines (mm) •L | seal (mm) •Weight | in kg •Clamping range | (mm)