



## TECHNICAL DATA SHEET

# KRASO® Sealing Insert Universal DD

### Application area

against pressing and non-pressing water, for core drillings or casings for installation of pipes or cables, with Torque Control Nut **KRASO® DKM**

### Technical drawing

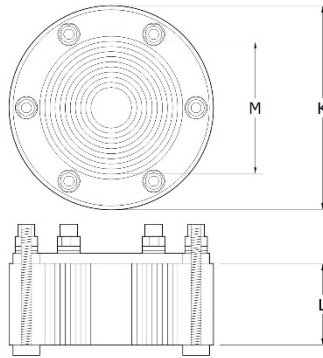

### Material

Clamping plates	non-corrosive stainless steel V2A
Bolts	non-corrosive stainless steel V2A
Washers	non-corrosive stainless steel V2A
Nuts	Torque Control Nut <b>KRASO® DKM</b>
Seal	EPDM 50° +/-5° Shore

### Technical details

- Torque Control Nut **KRASO® DKM**: integrated torque limiter – no torque wrench required
- Awarded with the Quality seal of FHRK e.V.
- Radon tightness IAF tested - meets the requirements for radon precautionary areas according to FHRK leaflet MB 101!
- Axial bending of the media pipes up to 8° possible
- MPA-tested gas- and water pressure tightness up to 3 bar
- DafStB waterproof concrete guideline: stress class 1 + 2

Test certificates [In our download area](#)



## TECHNICAL DATA SHEET

### KRASO® Sealing Insert Universal DD

						
	Universal 80 DD	Universal 100 DD	Universal 100 DD/T <small>(split design for retrofit installation)</small>	Universal 110 DD	Universal 110 DD/T <small>(split design for retrofit installation)</small>	Universal 150 DD
<b>K  </b>	80	100		110		150
<b>M  </b>	stepless onion ring technology: 18 - 43 mm or blind	stepless onion ring technology: 18 - 65 mm or blind		stepless onion ring technology: 18 - 75 mm or blind		110 90 75 blind
<b>L  </b>	40	40		40		40
<b>Weight  </b>	0,50	0,70		0,8		1,2
<b>Item no.  </b>	KDIUNI080	KDIUNI100	KDIUNIG100	KDIUNI110	KDIUNIG110	KDIUNI150

						
	Universal 150 DD/T <small>(split design for retrofit installation)</small>	Universal 160 DD/T	Universal 200 DD	Universal 200 DD/T <small>(split design for retrofit installation)</small>	Universal 250 DD	Universal 250 DD/T <small>(split design for retrofit installation)</small>
<b>K  </b>		160	200		250	
<b>M  </b>	110 90 75 blind	110 90 75 blind	160 135 125 110	160 135 125 110 blind	210 200 180 170	DN 200 SML-pipe DN 200 KG-pipe DN 200 KG 2000 DN 170 PE-pipe steel / cast pipe DN 160 KG-pipe, DN 160 SML-pipe
<b>L  </b>	40	40	40	40	40	40
<b>Weight  </b>	1,2	1,3	1,8	1,8	2,4	2,4
<b>Item no.  </b>	KDIUNIG150	KDIUNIG160	KDIUNI200	KDIUNIG200	KDIUNI250	KDIUNIG250

• K | core drilling (mm) • M | media lines (mm) • Seal | mm • Weight | in kg